



[www.numatic.co.uk](http://www.numatic.co.uk)

**GB**

*Original Instructions -*

*Warning! Read instructions before using the machine.*

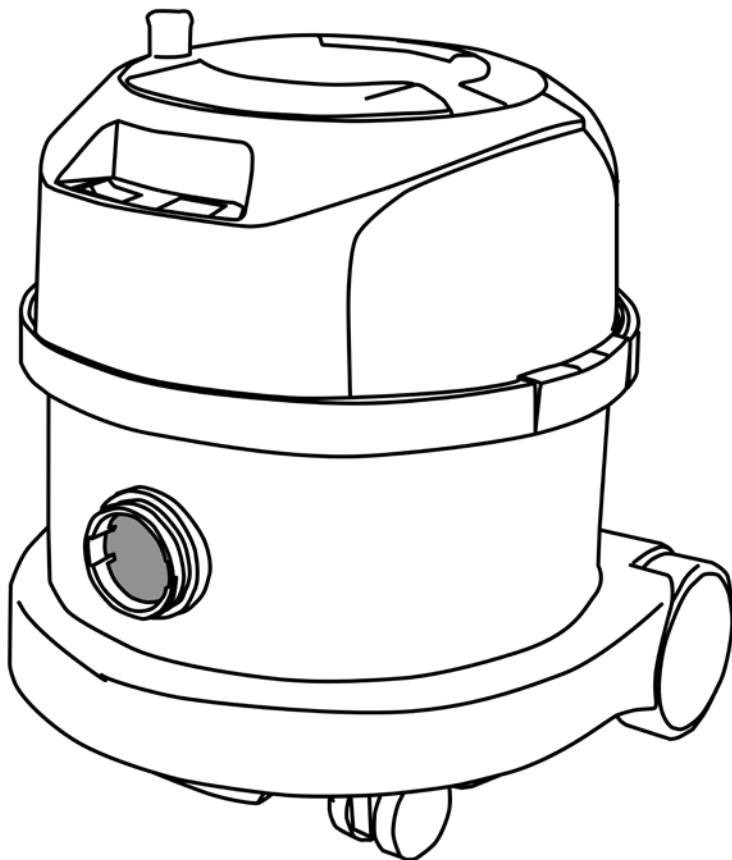

**AH1 - AS1 / c/w 901918, 601321, 601530 / AST1**

**PPR 180-11**

**PPR 240-11**

**PPR 370-11**

**PPR 380-11**



## Kit AH1 / AS1

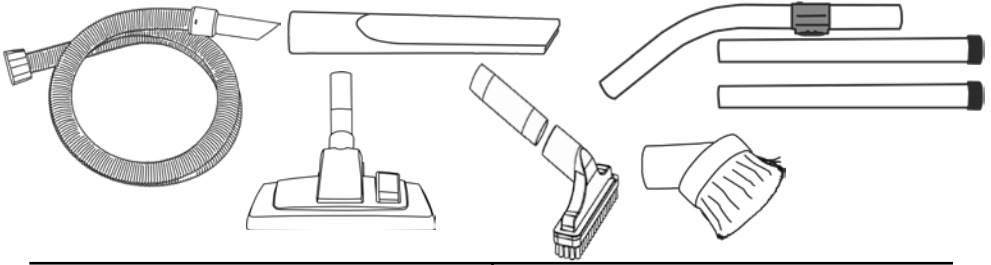

AS1 c/w 601321

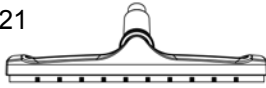

AS1 c/w 601530

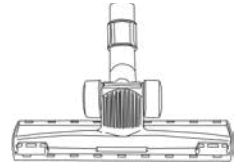

## Kit AST1

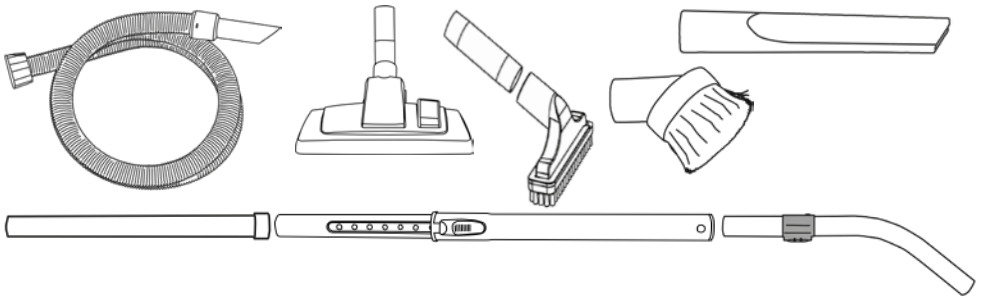

## Kit AH1 / AS1 c/w 900918

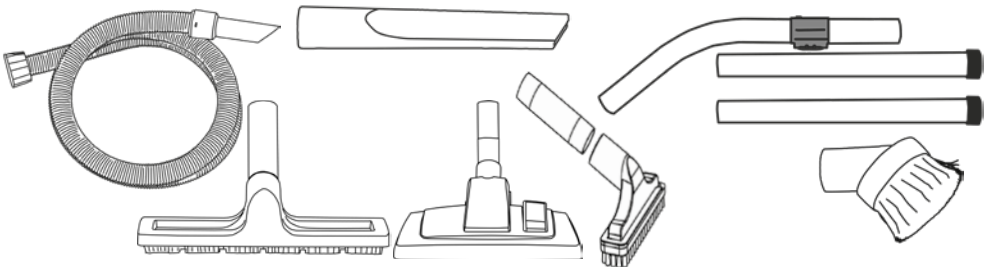

## Assembly



## Assembly

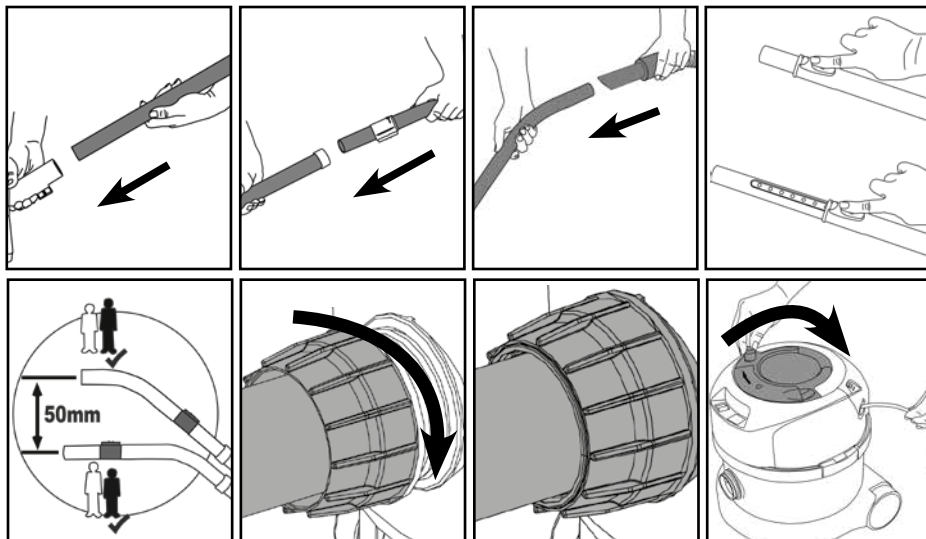

## Using your machine

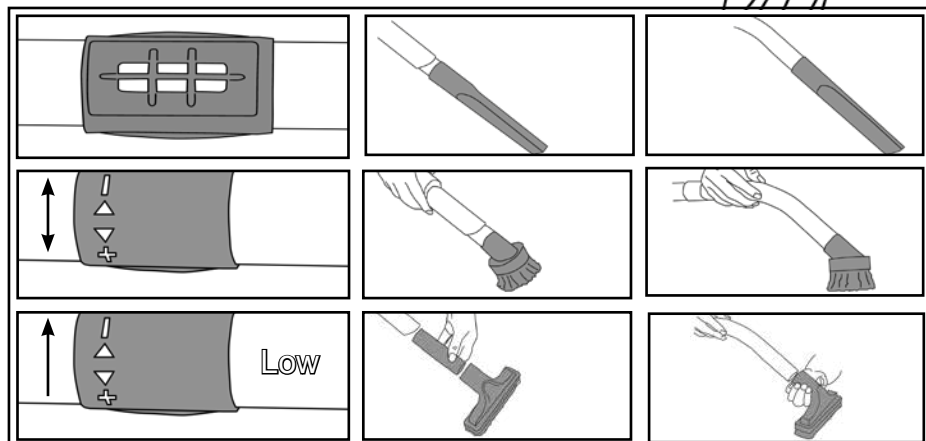
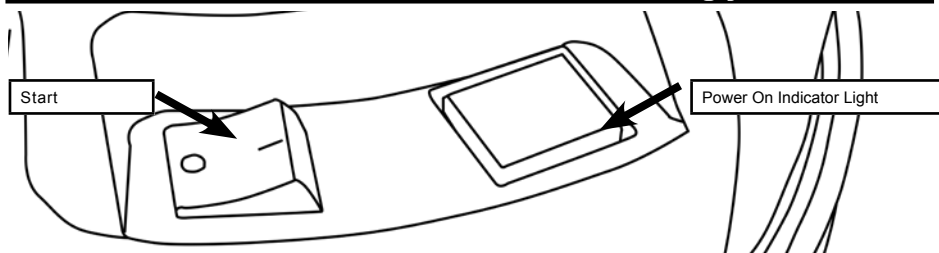

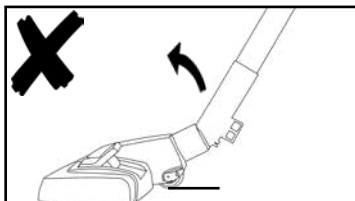
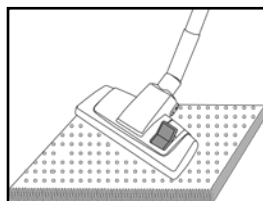
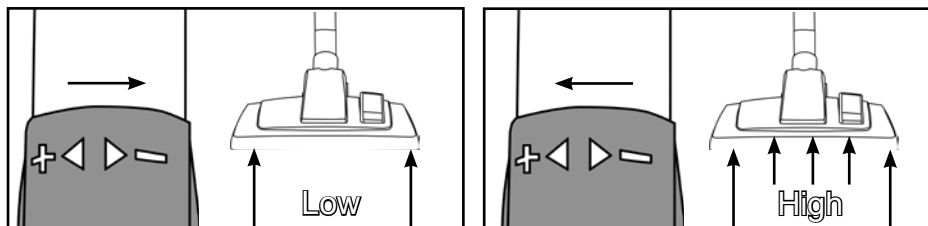

**PPR 240 only**

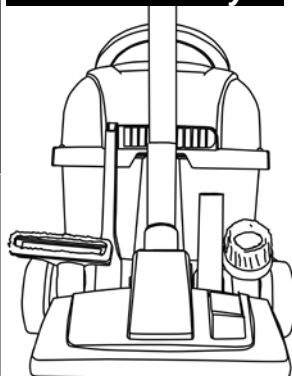
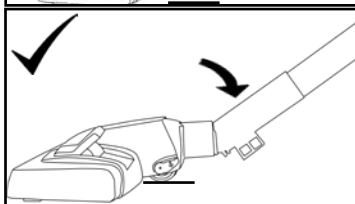
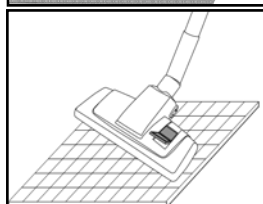

**Cleaning**

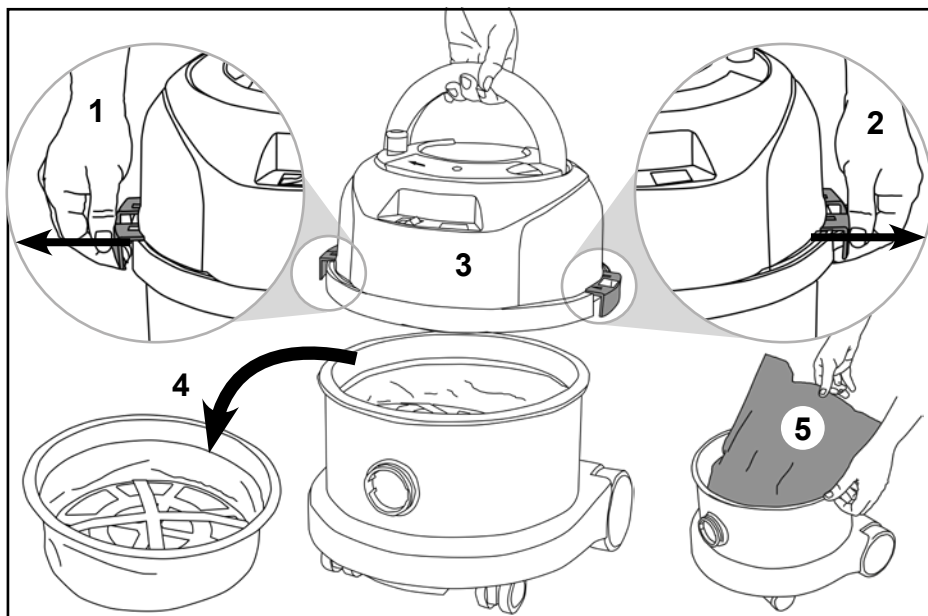

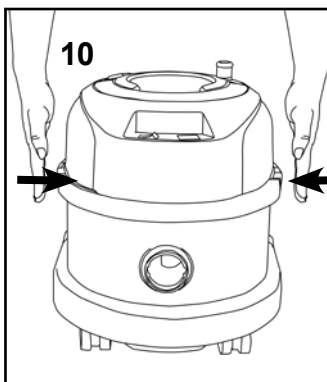
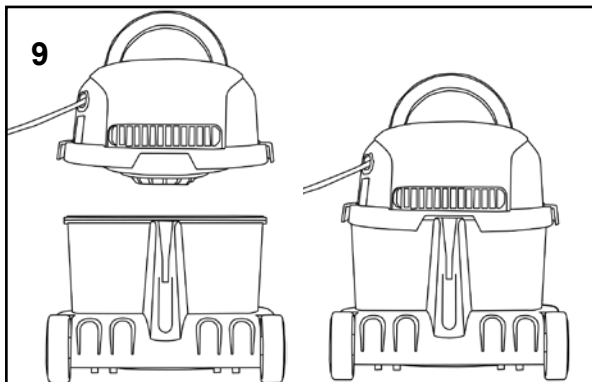
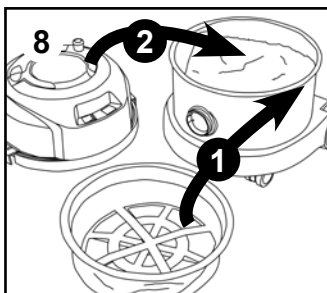
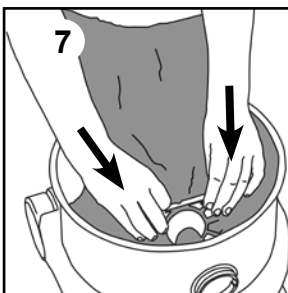
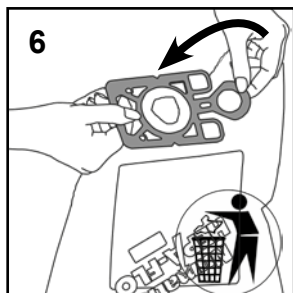

## Fitting the Face

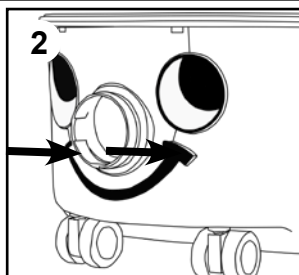
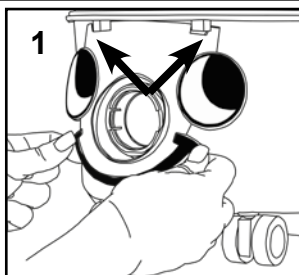

## Removing the Face

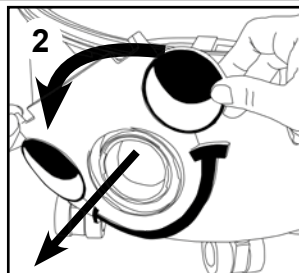
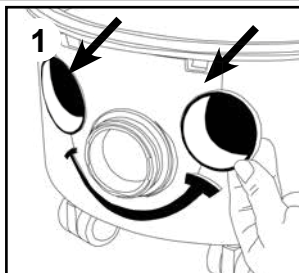

## PPR Plugged Cable

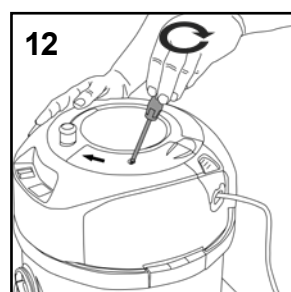
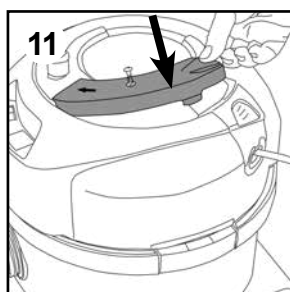
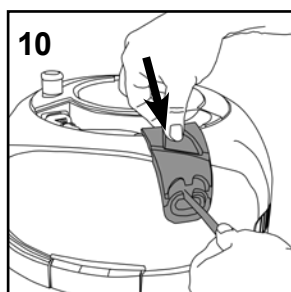
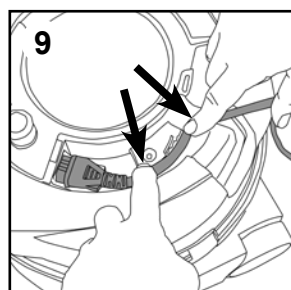
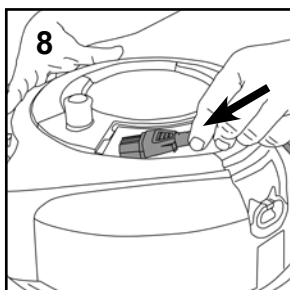
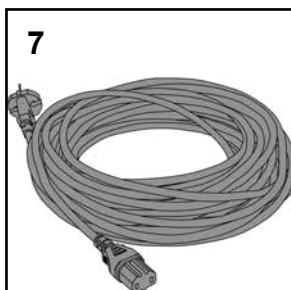
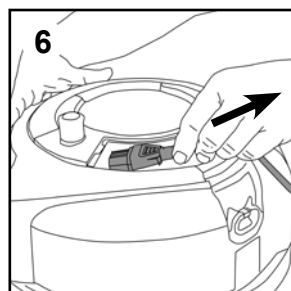
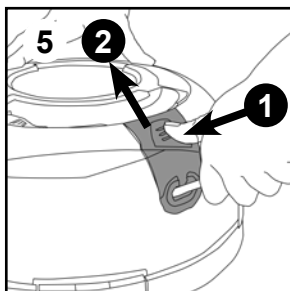
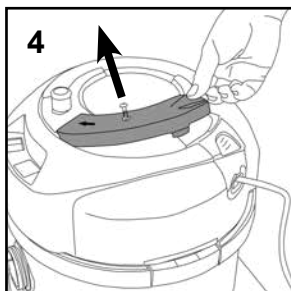
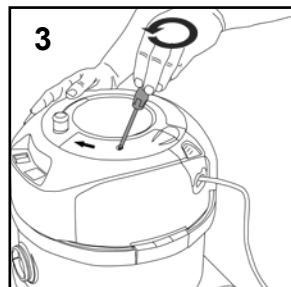
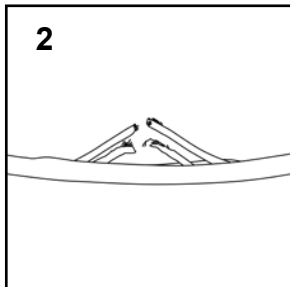
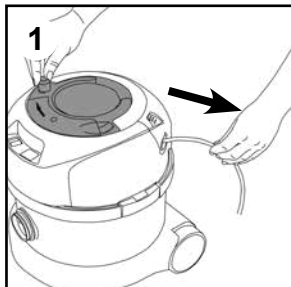

## Wand docking

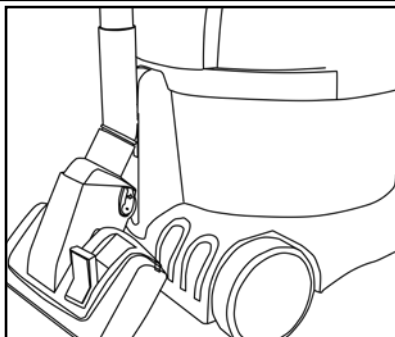
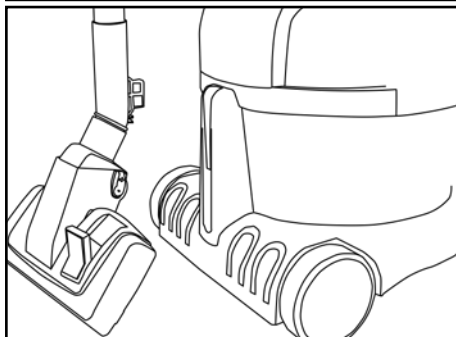

## Tool tidy PPR 240-11 only

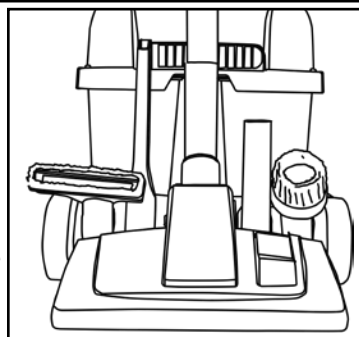
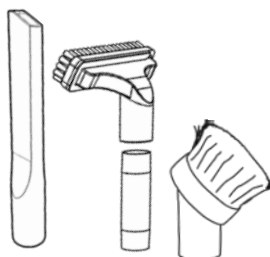
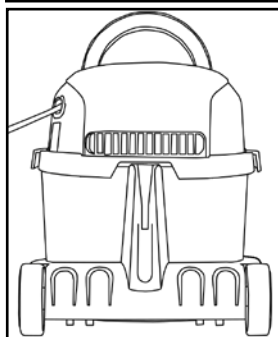

## Schematic Diagram

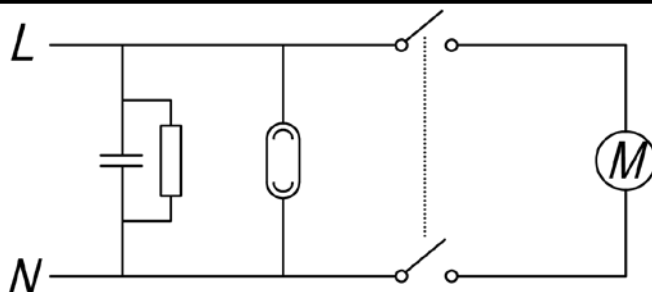

## Replacement parts

TriTex Filter	
604165	TriTex-Filter
HepaFlo Bags	
604015	NVM 1CH (Pack of 10) (240)
604016	NVM 2BH (Pack of 10) (370/380)

## About your machine

- 1 Voltage
- 2 Frequency
- 3 Rated Input Power
- 4 Weight (ready to work)
- 5 Company Name & Address
- 6 Model
- 7 Machine yr/wk Serial number
- 8 WEEE Logo
- 9 Protection Class 2 Symbol
- 10 CE Mark

### Rating Label



**PPE** (personal protective equipment) That may be required for certain operations.



Ear Protection



Safety Footwear



Head Protection



Safety Gloves



Eye Protection



Protective Clothing



Dust / Allergens Protection



Hi Vis Jacket

NOTE: A risk assessment should be conducted to determine which PPE should be worn.

### Safety Critical Components

**Mains leads:**

HO5-V2V2-F 12.5 x 2 x 1.00 mm<sup>2</sup>



Caution Floor Sign

### WEEE Legislation

**(Waste, Electrical and Electronic Equipment)**

Vacuum cleaner, accessories and packaging should be sorted for environmentally - friendly recycling.

*(Only for EU Countries)*

Do not dispose of vacuum cleaner into household waste! According to the European Directive 2012/19/EU on waste electrical and electronic equipment and its incorporation into national law.

Vacuum cleaners that are no longer suitable for use must be separately collected and sent for recovery in an environmentally - friendly manner.



Failure to rectify the problem or in the event of a breakdown contact your Numatic dealer or the Numatic Technical helpline +44 (0)1460 269268

### Daily

- Keep the machine clean, including hoses and tubes.
- Ensure the bag and filter are fitted.
- Regularly examine the power cord.
- Check dust bag frequently.
- Check filters are clean.

### Weekly - as daily and:-

- Check for any worn or damaged parts and replace immediately.
- Do not steam clean or pressure wash.

# GB



## Information for DRY use Vacuum cleaners

### WARNING!

***Read the instruction manual before using the machine.***

Operators shall be adequately instructed on the use of thier machine.

As with all electrical equipment, care and attention must be exercised at all times during use, in addition to ensuring that routine and preventative maintenance is carried out periodically to ensure safe operation.

Failure to carry out maintenance as necessary, including the replacement of parts to the correct standard could render this equipment unsafe and the manufacturer can accept no responsibility in this respect. Maintenance should only be carried out by a qualified person.

This machine is for DRY USE only and must not be stored outside or used in wet conditions.

The machine shall be disconnected from the mains by removing the plug from the supply socket during cleaning or maintenance and when replacing parts or converting the machine to another function.

The machine is not to be used by children or persons with reduced physical, sensory or mental capabilities, or lack of experience or knowledge, unless they have been given supervision or instruction.

This appliance is intended to be cleaned and maintained by an adult.

Children being supervised are not to play with the machine.

This machine is not a toy.

### CAUTION

This machine is not suitable for picking up hazardous or explosive dust.

Contact your local distributor if you require a machine capable of performing these tasks.

Ensure that the filtration system fitted to the machine is suitable for the material being collected.

This vacuum cleaner is intended for indoor use in the collection of dry materials.

This machine should be stored indoors only.

### NOTES

This machine is intended for commercial dry use, for cleaning onboard aircraft only.

This product complies with the requirements of clause 20 of IEC/EN 60335-2-69 Stability and Mechanical Hazards.

This vacuum cleaner is fitted with a thermal protection device. If the vacuum cleaner stops working, remove the plug from the wall before investigating where the fault lies.

If the vacuum cleaner has a blockage, switch off, remove the plug from the socket, inspect the floor tool, tubes and hose for debris. If the floor tool, tubes and hose are clear, replace the dust bag and clean the filter.

The vacuum cleaner should be inspected after use for damage.

Not suitable for the collection of biological hazards, hazardous, or explosive dusts .

The vacuum cleaner should be stored in a dry place.

### DO

- Keep your machine clean including hoses and tubes.
- Change dust bag frequently.
- Keep filters clean.
- Keep diffuser filter (where fitted) clean.
- Use filter bags, they will enhance performance and help keep machine clean.
- Use a Numatic Original filter bag under fine dust conditions.
- Keep hoses and tubes clear.
- Replace any worn or damaged parts immediately.
- Only use the socket outlet on the machine for purposes specified in the instructions.
- Only use the brushes provided with the machine. The use of other brushes may impair safety.
- Regularly examine the power cord. If damage is found such as cracking or ageing the power cord must be replaced by a qualified person.
- Only replace the power cord with the correct Numatic approved replacement part.

### DO NOT

- Pull on the cable to unplug the machine from the power supply.
- Use to suck up hot ashes or lighted cigarette ends.
- Use steam cleaners or pressure washers to clean the machine or use in the rain.
- Immerse in water for cleaning.
- Attempt machine maintenance or cleaning unless the power supply plug has been removed from the supply outlet.
- Do not use in wet environments or to collect wet materials.

# Numatic International Warranty

Numatic International Limited warrant to the original purchaser that its products are free of defects in both material or workmanship for the period shown below:-

<b>Homecare and Cleancare Vacuum cleaners.....</b>	<b>2 Years</b>
<b>Rotary Floor Machines.....</b>	<b>2 Years</b>
<b>Twintec Auto Scrubber Dryer.....</b>	<b>1 Year</b>
<b>Mopping, Compacts, Combi and Servocare Products.....</b>	<b>1 Year</b>
<b>Individual Accessories and Spare Parts.....</b>	<b>6 Months</b>

Note: This warranty expressly excludes consumable parts such as carbon brushes, floor brushes, mops, batteries etc, that are considered replaceable from time to time during the normal working life of the machine.

A. The warranty period commences from the date the goods are purchased.

B. All warranty claims must be processed through the Dealer from whom the equipment was purchased. The Dealer will co-operate with the purchaser throughout the warranty claims procedure and will arrange any necessary repairs using genuine Numatic parts.

C. If the original Dealer is no longer able to fulfil his obligations please contact Numatic International Limited with full details of the claim and proof of purchase so that this may be processed without delay.

D. Any warranty claim can only relate to the specific part that is proven to be at fault and for which a replacement will be supplied but cannot be extended to constitute a claim against the complete machine.

E. Numatic International will supply the Dealer with any warranty parts required, subject to the claim being validated, after return of the faulty items in accordance with Numatic International Limited's General Conditions of Sale.

F. Claims will not be accepted if they are the result of fair wear and tear, misuse or abuse of any kind.

G. No replacement will be given unless the appropriate evidence of the validity of the claim has been provided to the satisfaction of Numatic International Limited.

H. Numatic International Limited reserve the right to charge for any unnecessary work carried out as a result of an invalid claim.

I. No variation to this warranty may be made or implied by any member of Numatic International Limited or its Dealers unless such variation is in writing and authorised by the Company.



**Numatic International Limited. Chard, Somerset, TA20 2GB**  
**Telephone: 01460 68600 Fax: 01460 68458**  
**© Numatic International Limited 2016**



**EU DECLARATION  
OF  
CONFORMITY**

We hereby declare under our sole responsibility that the following equipment fulfils all the relevant provisions of the following EU Directives:

Machinery Directive 2006/42/EC

EMC Directive 2014/30/EU

RoHS Directive 2011/65/EU

Energy labelling of vacuum cleaners EU/665/2013 - 2010/30/EU

Eco design requirements for vacuum cleaners EU/666/2013 - 2009/125/EC

**Machine Description:** **Vacuum Cleaner**  
**Type:** PPR, PPT, PPH, NPR, NPT, HXL, PVT, NFR series

**Manufactured by:** **Numatic International Limited**

Relevant standards upon which conformity is declared include:

IEC 60335-1

EN 60335-1:2012

IEC 60335-2.2

IEC 60335-2.69

EN 60335-2.69:2012

EN 55014-1:2006

EN 55014-2:1997 +A1:2001 (Cat II)

EN 61000-3-2:2006

EN 61000-3-3:1995 +A1+A2

EN 62233:2008

A technical construction file for this equipment is retained at the manufacturer's address under the authorisation of the following signatory:

**Name:** Allyn Boyes

**Position:** Technical Manager

Signed:

Date: 20/04/2016



Numatic International Limited,  
Chard, Somerset.  
TA20 2GB  
[www.numatic.co.uk](http://www.numatic.co.uk)

**GB**

# Data

	1	2	3	4	5	6
180	8 L	31.4 m	7.6 kg	64 dB (A)	Class II	340 x 360 x 360 mm
240	9 L		9.0 kg	Uncertainty		360 x 370 x 415 mm
370	15L		10,0 kg	0.5 dB		360 x 370 x 510 mm
380	15L		10.0 kg			360 x 360 x 510 mm

1	2	3	4	5	6
Drum Size	Cleaning Range	Weight (Ready to work)	Sound Pressure	Protection Class	Dimensions

<b>Model ID</b> Vacuum Cleaners - EU Data Sheet In accordance with (EU) Regulation No 665/2013 Numatic International	PPR 180 PPR 240 PPR 370 PPR 380 Kit AH1 Kit AS1	PPR 180 PPR 240 PPR 370 PPR 380 AH1/AS1 c/w 900918	PPR 180 PPR 240 PPR 370 PPR 380 AH1/AS1 c/w 601530	PPR 180 PPR 240 PPR 370 PPR 380 AH1/AS1 c/w 601321	PPR 180 PPR 240 PPR 370 PPR 380 Kit AST1
<b>Energy efficiency class</b>	A	A	A	A	A
<b>Annual energy consumption in kWh per annum</b> Indicative annual energy consumption (kWh per year), based on 50 cleaning tasks. Actual annual energy consumption will depend on how the appliance is used.	25.2	25.2	25.2	25.2	26.4
<b>Cleaning performance on carpet</b>	C	C	C	C	D
<b>Cleaning performance on hard floor</b>	C	C	A	C	C
<b>Dust re-emission</b>	C	C	C	C	C
<b>Sound power level db (A)</b>	72	72	72	72	72
<b>Rated input power W</b>	620	620	620	620	620

**Numatic International Limited, Chard, Somerset,  
TA20 2GB**

**Telephone: 01460 68600**

**Fax: 01460 68458**

Specification subject to change without prior notice  
www.numatic.co.uk © Numatic International Limited

244449 03/18 (A11)